

## Care and Maintenance of the Scale

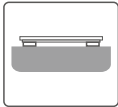

- Always keep the scale in horizontal position, and not put it in wet or hot condition.
- Avoid hitting or dropping the scale otherwise damage may occur.
- Do not put heavy things on the scale when not use.
- Do not overload otherwise the sensor may damage.

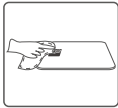

- Treat the scale with care as it is a highly precise electronic instrument.
- Do not immerse this product in water.
- Clean the scale with a soft damp cloth, do not use chemicals or harsh abrasives.



- Keep the scale surface dry and do not use it on slippery floor.
- Do not weigh with wet feet to avoid slipping.
- The product is not for trade use.

## Battery Advice



- If the scale is not to be used for long periods, it's recommended to remove the battery to avoid damage to the scale due to possible battery leakage.
- Keep the batteries out of reach of children.



- Do not mix old and new batteries, with different compositions or of different brands in order to prevent possible leakage, explosion.
- Do not heat or deform the batteries or expose to fire.



- Waste batteries should not be disposed of with household waste.
- Please check with your local authority for battery recycling advice.



Waste electrical products should not be disposed of with household waste. Please recycle where facilities exist. Check with your Local Authority or retailer for recycling advice.

## Electronic Bathroom Scale Instruction Manual

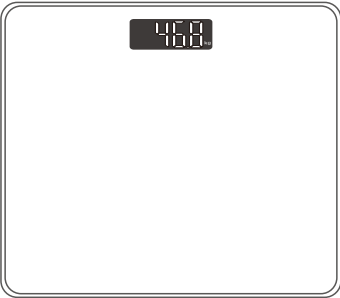

Please read the instructions carefully before operating.

## Product Specification

Product size	300x260x18mm
Power	2 x 1.5V AAA batteries
Display	LCD readout display
Max Capacity	150kg/300lb
Division	100g/0.2lb
Minimum effective weight	8kg

## Product Feature

- Auto on/ Auto off
- Auto zero resetting
- Weight units: kg-lb
- Low battery/ over-load indication

## Product Structure

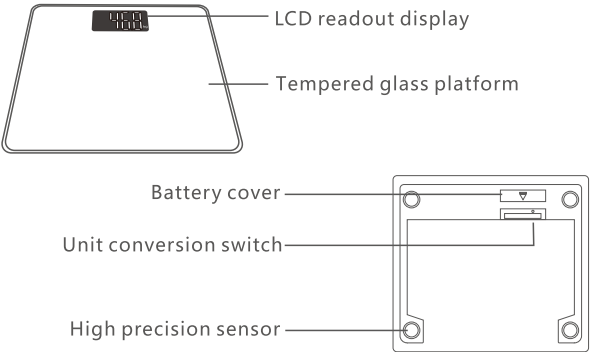

-1-

## To Insert or Replace Battery

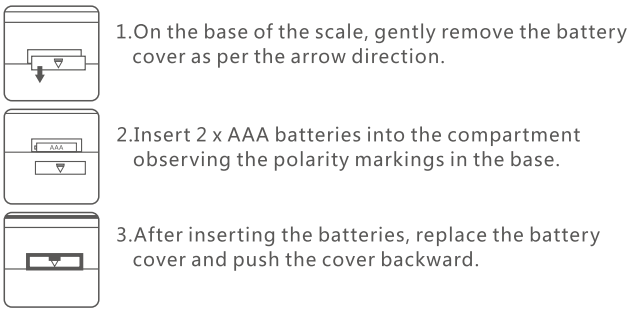

Kind notice:  
Please be aware that the incorrect polarity will cause the permanent impact on the electronic parts.

## Operation

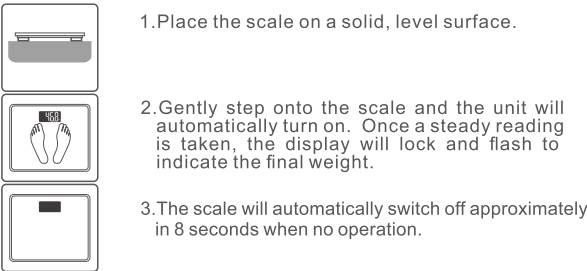

Kind notice:  
1. Do not place the scale on carpet or similar soft surfaces otherwise accuracy will be compromised.  
2. Please keep balance in weighing. Do not let the body in wobbling.

-2-

## Unit Conversion

If the scale is with unit systems of Metric(kilograms) and Imperial (pounds), users can select units from kg(kilograms) to lb(pounds).

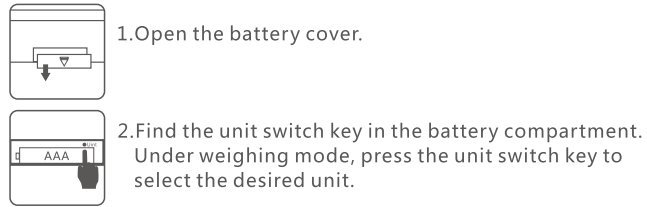

## Error Indication

 The "Lo" symbol on the display indicates that the battery power is running low. Please replace new battery.

 The "Err" symbol on the display indicates that the scale is over-loaded. Please step off to avoid possible damage to the product.

 If the "Error" symbol is shown on the display as you step off the scale, it indicates that an error has occurred. Please step back to weight again.

-3-